



PROFILE OF INNOVATION

Schlüter®-KERDI-BOARD

Substrate, building panel, bonded waterproofing

Suggested Retail Price Sheet

Schluter®-KERDI-BOARD

Schluter®-KERDI-BOARD is a multifunctional tile substrate and building panel, which can also be used for creating bonded waterproofing assemblies with tile coverings.

It consists of an extruded polystyrene foam panel, with a special reinforcement material on both sides and fleece webbing for effective anchoring in thin-set mortar.

With the available panel thicknesses of 3/16", 3/8", 1/2", 3/4", 1", 1-1/2", and 2" (5, 9, 12.5, 19, 25, 38, and 50 mm), KERDI-BOARD allows the installer to prepare and create a broad range of substrates and building elements for the installation of ceramic and natural stone tile that are flat, level, plumb, square, and dimensionally stable. With suitable preparation of the abutting seams and joint areas, the panel may be used for bonded waterproofing assemblies.

The boards are simply cut to size with a utility knife. The gridlines, which are printed on the surface, are helpful for neat and quick cuts and installation.

Tiles can be installed directly over KERDI-BOARD using the thin-set method.

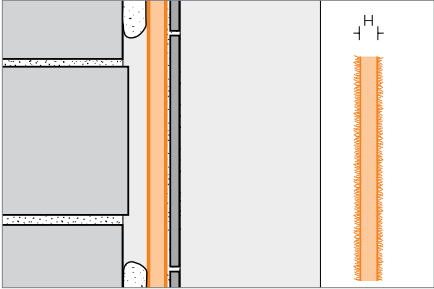

i
 KERDI-BOARD panels are shipped in bundles only. Please order in multiples of the bundle quantity.
 Bundles are packaged using protective endcaps to prevent damage. Additional protective endcaps are included on each pallet to allow for repackaging of bundles as needed.

Schluter®-KERDI-BOARD				
Substrate and building panel				
H = mm - in.	Item No.	\$ / Panel	Panels / Bundle	\$ / Bundle
Panel dimension: 122 cm x 162.5 cm – 48" x 64"				
5 - 3/16	KB 5 1220 1625	70.78	10	707.80
9 - 3/8	KB 9 1220 1625	74.24	8	593.92
12.5 - 1/2	KB 12 1220 1625	77.71	6	466.26
Panel dimension: 122 cm x 244 cm – 48" x 96"				
5 - 3/16	KB 5 1220 2440	106.13	6	636.78
9 - 3/8	KB 9 1220 2440	111.34	5	556.70
12.5 - 1/2	KB 12 1220 2440	116.54	5	582.70
Panel dimension: 62.5 cm x 244 cm – 24-1/2" x 96"				
19 - 3/4	KB 19 625 2440	63.71	6	382.26
25 - 1	KB 25 625 2440	67.66	4	270.64
38 - 1-1/2	KB 38 625 2440	77.54	3	232.62
50 - 2	KB 50 625 2440	87.10	3	261.30

Schluter®-KERDI-BOARD-V

Schluter®-KERDI-BOARD-V is a vertically grooved substrate and building panel for creating curved elements. If a larger expanse of panels is required, several panels can be connected along the edges with thin-set mortar, Schluter®-KERDI-FIX adhesive, or double-sided adhesive tape.

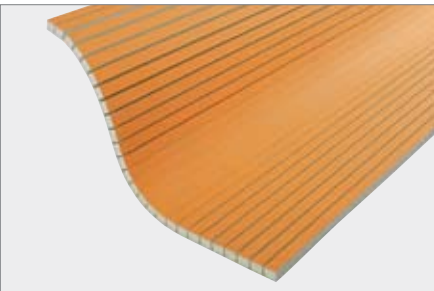
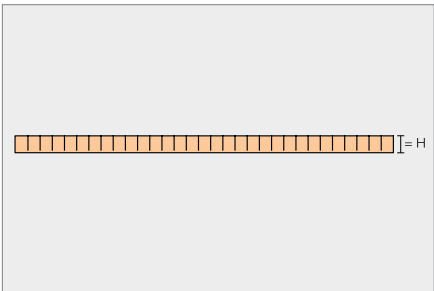

Schluter®-KERDI-BOARD-V				
Grooved substrate and building panel				
H = mm - in.	Item No.	\$ / Panel	Panels / Bundle	\$ / Bundle
Panel dimension: 62.5 cm x 244 cm – 24-1/2" x 96"				
9 - 3/8	KB 9 625 2440 V	72.12	10	721.20
12.5 - 1/2	KB 12 625 2440 V	74.78	10	747.80
19 - 3/4	KB 19 625 2440 V	77.43	6	464.58
25 - 1	KB 25 625 2440 V	84.34	4	337.36
38 - 1-1/2	KB 38 625 2440 V	92.84	3	278.52
50 - 2	KB 50 625 2440 V	102.40	3	307.20



Schluter®-KERDI-BOARD-E

Schluter®-KERDI-BOARD-E is an L-shaped panel used to create corners and pipe or column coverings.

The panels feature a V-shaped groove and are shipped in a space-saving flat design, which makes them easy to store. The flat panels are also quick to cut to the necessary dimensions. Thin-set mortar, Schluter®-KERDI-FIX adhesive, or double-sided adhesive tape is applied to the V-groove. The panels are then folded prior to installation.

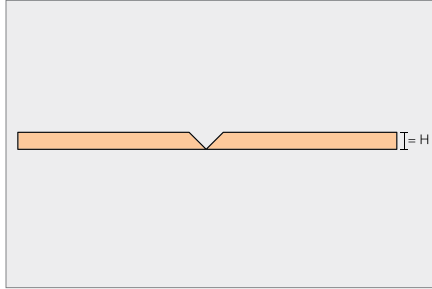

Schluter®-KERDI-BOARD-E				
L-shaped panel				
H = mm - in.	Item No.	\$ / Panel	Panels / Bundle	\$ / Bundle
Panel dimension: 62.5 cm x 244 cm – 24-1/2" x 96"				
12.5 - 1/2	KB 12 625 2440 E	80.92	10	809.20
19 - 3/4	KB 19 625 2440 E	83.53	6	501.18
25 - 1	KB 25 625 2440 E	88.67	4	354.68

Schluter®-KERDI-BOARD-U

Schluter®-KERDI-BOARD-U is a U-shaped panel used to create pipe or column coverings.

The panels feature V-shaped grooves and are shipped in a space-saving flat design, which makes them easy to store. The flat panels are also quick to cut to the necessary dimensions. Thin-set mortar, Schluter®-KERDI-FIX adhesive, or double-sided adhesive tape is applied to the V-grooves. The panels are then folded prior to installation.

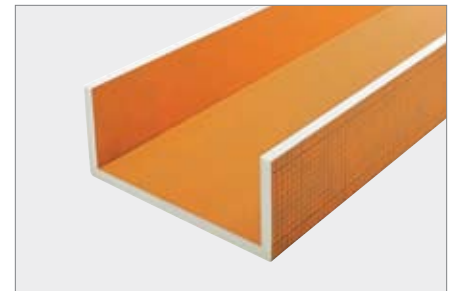
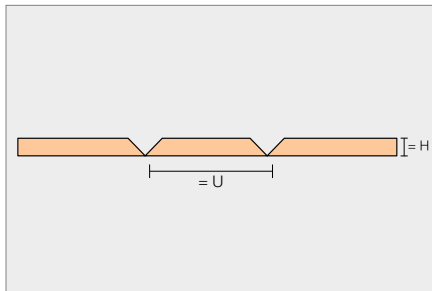

Schluter®-KERDI-BOARD-U				
U-shaped panel				
H = mm - in.	Item No.	\$ / Panel	Panels / Bundle	\$ / Bundle
Panel dimension: 62.5 cm x 244 cm – 24-1/2" x 96"				
U = 20 cm – 7-7/8"				
19 - 3/4	KB 19 625 2440 U 20	104.84	6	629.04
U = 30 cm – 11-13/16"				
19 - 3/4	KB 19 625 2440 U 30	104.84	6	629.04



Schluter®-KERDI-BOARD-ZW

Schluter®-KERDI-BOARD-ZW is a stainless steel angle profile with two trapezoid perforated anchoring legs. It is used to fasten and stabilize structures made of KERDI-BOARD panels. It is attached to the substrate with either screws or thin-set mortar.

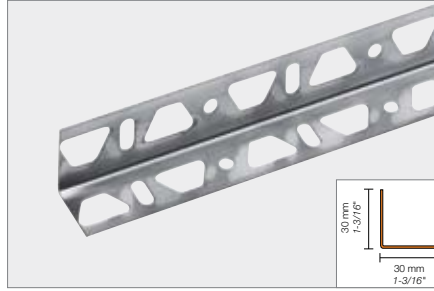

Schluter®-KERDI-BOARD-ZW	
Stainless steel angle profile	
Item No.	\$ / Length
Length = 15 cm - 6"	
KB ZW 30 E/15	1.61
Length = 2.50 m - 8' 2-1/2"	
KB ZW 30 E	23.98

Schluter®-KERDI-BOARD-ZC

Schluter®-KERDI-BOARD-ZC is a brushed stainless steel, U-shaped profile with one perforated anchoring leg. It is used to finish the edges of countertops, vanities, and similar structures in conjunction with the Schluter®-RONDEC or Schluter®-QUADEC finishing profiles.

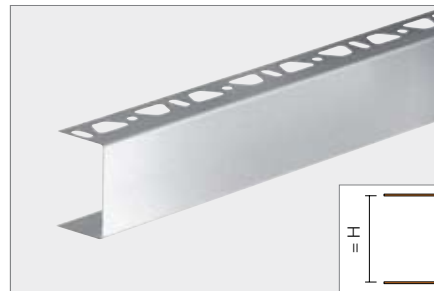

Schluter®-KERDI-BOARD-ZC		
U-shaped brushed stainless steel profile with 1 perforated anchoring leg		
H = mm - in.	Item No.	\$ / Length
Length = 2.50 m - 8' 2-1/2"		
38 - 1-1/2	KB ZC 38 EB	56.70
50 - 2	KB ZC 50 EB	61.95

Schluter®-KERDI-BOARD-ZC/E		
Brushed stainless steel outside corner piece for ZC		
H = mm - in.	Item No.	\$ / Unit
38 - 1-1/2	E/KB ZC 38 EB	20.44
50 - 2	E/KB ZC 50 EB	20.44

Schluter®-KERDI-BOARD-Z/V		
Brushed stainless steel connector for ZC and ZA		
H = mm - in.	Item No.	\$ / Unit
19 - 3/4	V/KB Z 19 EB	6.44
25 - 1	V/KB Z 25 EB	6.44
38 - 1-1/2	V/KB Z 38 EB	6.44
50 - 2	V/KB Z 50 EB	6.44

Schluter®-KERDI-BOARD-ZI/V		
Stainless steel internal connector for ZC and ZA		
H = mm - in.	Item No.	\$ / Unit
19 - 3/4	V/KB ZI 19 E	3.99
25 - 1	V/KB ZI 25 E	3.99
38 - 1-1/2	V/KB ZI 38 E	3.99
50 - 2	V/KB ZI 50 E	3.99



Schluter®-KERDI-BOARD-ZA

Schluter®-KERDI-BOARD-ZA is a brushed stainless steel, U-shaped profile with two perforated anchoring legs. It is used to finish visible edges of partition walls and shelves.

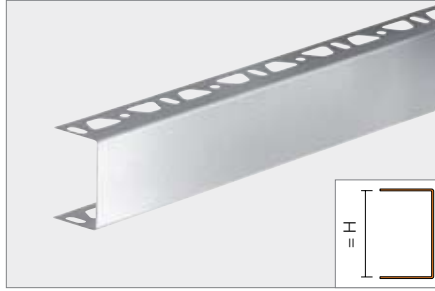

Schluter®-KERDI-BOARD-ZA		
U-shaped brushed stainless steel profile with 2 perforated anchoring legs		
H = mm - in.	Item No.	\$ / Length
Length = 2.50 m - 8' 2-1/2"		
19 - 3/4	KB ZA 19 EB	48.13
25 - 1	KB ZA 25 EB	51.98
38 - 1-1/2	KB ZA 38 EB	56.70
50 - 2	KB ZA 50 EB	61.95

Schluter®-KERDI-BOARD-ZA/E		
Brushed stainless steel outside corner piece for ZA		
H = mm - in.	Item No.	\$ / Unit
38 - 1-1/2	E/KB ZA 38 EB	20.44
50 - 2	E/KB ZA 50 EB	20.44

Schluter®-KERDI-BOARD-Z/V		
Brushed stainless steel connector for ZC and ZA		
H = mm - in.	Item No.	\$ / Unit
19 - 3/4	V/KB Z 19 EB	6.44
25 - 1	V/KB Z 25 EB	6.44
38 - 1-1/2	V/KB Z 38 EB	6.44
50 - 2	V/KB Z 50 EB	6.44

Schluter®-KERDI-BOARD-ZI/V		
Stainless steel internal connector for ZC and ZA		
H = mm - in.	Item No.	\$ / Unit
19 - 3/4	V/KB ZI 19 E	3.99
25 - 1	V/KB ZI 25 E	3.99
38 - 1-1/2	V/KB ZI 38 E	3.99
50 - 2	V/KB ZI 50 E	3.99

Schluter®-KERDI-BOARD-ZB

Schluter®-KERDI-BOARD-ZB is a stainless steel, U-shaped profile with three-sided perforation. It is used to fasten and stabilize partition walls and other structures made of KERDI-BOARD panels. The surfaces of the profile are hidden by the tile covering.

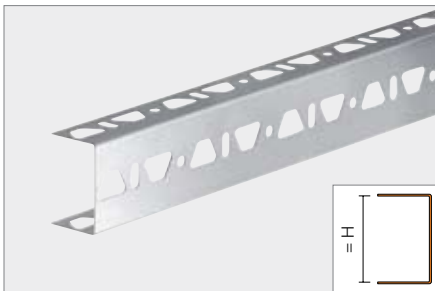

Schluter®-KERDI-BOARD-ZB		
U-shaped stainless steel profile with 3 perforated anchoring legs		
H = mm - in.	Item No.	\$ / Length
Length = 2.50 m - 8' 2-1/2"		
19 - 3/4	KB ZB 19 E	41.48
25 - 1	KB ZB 25 E	44.80
38 - 1-1/2	KB ZB 38 E	48.48
50 - 2	KB ZB 50 E	53.20



Schluter®-KERDI-BOARD-ZSD

Schluter®-KERDI-BOARD-ZSD are anchors used to provide additional mechanical attachment of KERDI-BOARD when the bond between the thin-set mortar and the substrate is questionable.

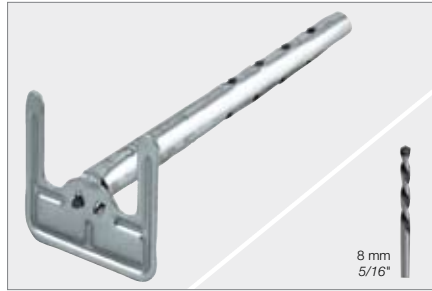

Schluter®-KERDI-BOARD-ZSD			
Stainless steel anchor			
Size = cm - in.	Item No.	Anchors / Box	\$ / Box
9 - 3-1/2	KB ZSD 90 E	25	27.65
11 - 4-5/16	KB ZSD 110 E	25	31.92
Galvanized steel anchor			
9 - 3-1/2	KB ZSD 90 Z	25	14.84
11 - 4-5/16	KB ZSD 110 Z	25	17.08

Schluter®-KERDI-BOARD-ZT

Schluter®-KERDI-BOARD-ZT are galvanized steel washers used to fasten KERDI-BOARD to stud framing. They feature tabs that penetrate the surface of the KERDI-BOARD and temporarily hold the washers in place to enable quick installation of the corresponding screws.

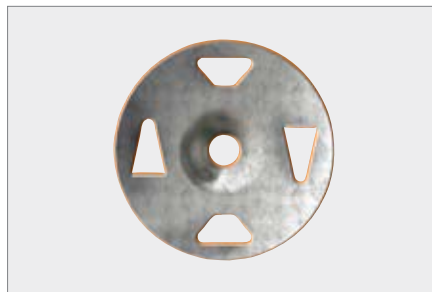

Schluter®-KERDI-BOARD-ZT			
Galvanized steel attachment washer			
Size = mm - in.	Item No.	Washers / Box	\$ / Box
32 - 1-1/4	KB ZT 32 Z	100	10.98

Schluter®-KERDI-BOARD-ZS

Schluter®-KERDI-BOARD-ZS are screws used to fasten KERDI-BOARD to stud framing with the corresponding washers.

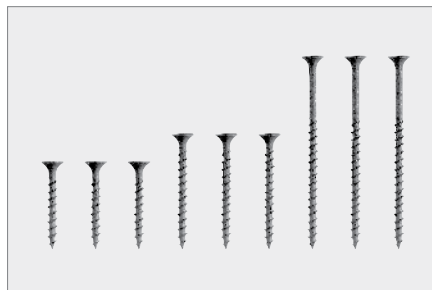

Schluter®-KERDI-BOARD-ZS			
Coarse thread screw for wood framing			
Size = mm - in.	Item No.	Screws / Box	\$ / Box
41 - 1-5/8	KB ZS 35 G	200	14.98
50 - 2	KB ZS 55 G	100	10.98
75 - 3	KB ZS 75 G	100	16.76



Schluter®-KERDI-BOARD-ZDK

Schluter®-KERDI-BOARD-ZDK is a double-sided adhesive tape used to attach KERDI-BOARD panels in joint areas or similar.



Schluter®-KERDI-BOARD-ZDK			
Double-sided tape			
Item No.	Width mm - in.	Length m - ft.	\$ / Roll
KB ZDK 12/10 M	12.5 - 1/2	10 - 33	9.17
KB ZDK 19/10 M	19 - 3/4	10 - 33	14.21
KB ZDK 30/10 M	30 - 1-3/16	10 - 33	22.33

Schluter®-KERDI-BOARD-ZSA

Schluter®-KERDI-BOARD-ZSA is an adhesive tape for reinforcing the joint areas of KERDI-BOARD panels.



Schluter®-KERDI-BOARD-ZSA			
Joint reinforcement tape			
Item No.	Width mm - in.	Length m - ft.	\$ / Roll
KB ZSA 100/45 M	100 - 4	45 - 148	16.31

Schluter®-KERDI-BOARD-ZFP

Schluter®-KERDI-BOARD-ZFP is a flat plastic profile, which is adhered behind the KERDI-BOARD-ZA U-shaped profile to improve fastening of hardware with screws.



Schluter®-KERDI-BOARD-ZFP		
Flat plastic profile		
Width mm - in.	Item No.	\$ / Length
Length = 2.50 m - 8' 2-1/2"		
35 - 1-3/8	KB ZFP 35	10.50



P R O F I L E O F I N N O V A T I O N

Schluter Systems L.P. • 194 Pleasant Ridge Road, Plattsburgh, NY 12901-5841 • Tel.: 1-800-472-4588 • Fax: 1-800-477-9783
Schluter Systems (Canada) Inc. • 21100 Chemin Ste-Marie, Ste-Anne-de-Bellevue, QC, H9X 3Y8 • Tel.: 1-800-667-8746 • Fax: 1-877-667-2410
e-mail: info@schluter.com

www.schluter.com

552986

Date: 05/10

© 2010 Schluter Systems L.P.